



Conservatory awnings Climara, on glass

Conservatory awnings Climara W19

Durable

Tested technology in a new design: The durable counter-pull system is given additional protection against soiling with a brush seal, and work particularly reliably.

Combinable

All-in-one: In combination with the Climara D3, a uniform appearance is created - also for architecturally unique conservatories.

Expansive

Extensive sun shading system: The awning shades larger areas optimally.

Construction limit values

Maximum order width	6000 mm
Maximum order length	6000 mm
Maximum order area	30 m ²
Maximum order width of the group unit	12000 mm

Order here

myWAREMA

[Art.-Nr. 2036172](#)

Order form

<https://docs.warema.com/fi/2019603.pdf>

WAREMA tools

[Collection Assistant](#)

[Sun Shading Planner](#)

[+ see "Navigating the document", Page 5](#)

Components

Climara W19 conservatory awning

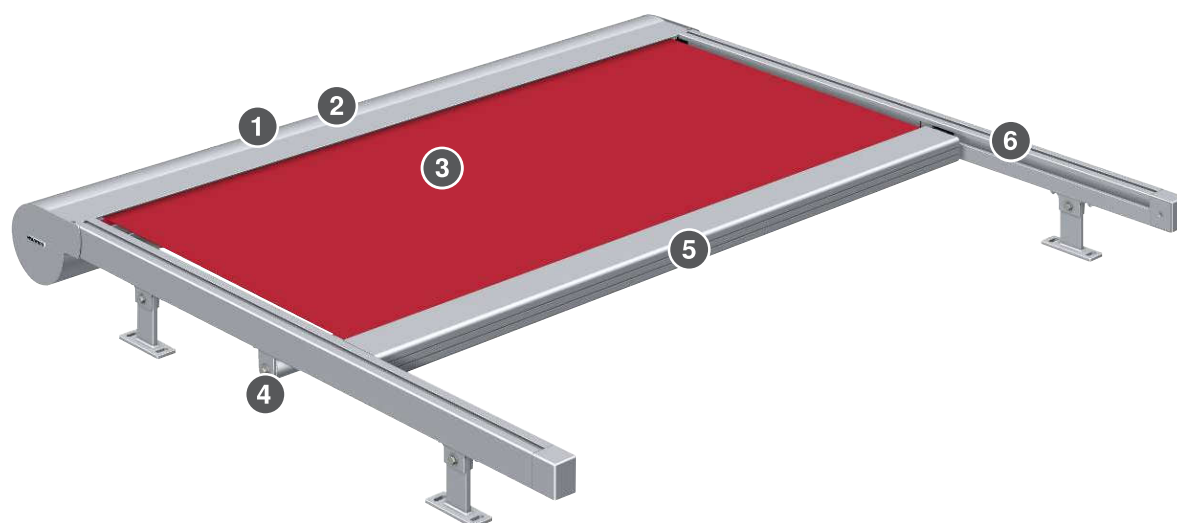

- 1 Cover panel
- 2 Shaft
- 3 Awning fabric

- 4 Reinforcement profile
- 5 Front rail
- 6 Guide rail

Cover panel

Round cover panel - D3/W9/W10/W10²/W19/W20

Material	Aluminium, extruded
Surface	Powder-coated
Width	199 mm
Height	158 mm

+ Side cover

Side cover for round cover panel - D3/W9/W10/W10²/W19/W20

Material	Aluminium
Surface	Powder-coated
Width	227 mm
Height	159 mm

Shaft

Fabric shaft Ø 85 mm

Material	Galvanised steel
Surface	Plain
Profile	Groove tube
Diameter	85 mm

Motor shaft Ø 56 mm

Material	Aluminium
Surface	Plain
Profile	Round profile
Diameter	56 mm

Front rail

Front rail - W9/W10/W10²/W19/W20/P20/H1

Material	Aluminium, extruded
Surface	Powder-coated
Width	94 mm
Height	54 mm

Reinforcement profile

Reinforcement profile Ø 40 mm

Material	Aluminium, extruded
Surface	Powder-coated
Diameter	40 mm

Reinforcement profile Ø 60 mm

Material	Aluminium, extruded
Surface	Powder-coated
Diameter	60 mm

Bracket

- Bracket H11
- Bracket H34
- Bracket H36
- Bracket H41
- Bracket H60
- Bracket H81
- Bracket H82
- Bracket H62
- Bracket H101
- Bracket H102

+ see "Guide rail bracket - Climara conservatory awnings", Page 418

Guide variants

- Back-pull

Guide rail

Guide rail - D3/W9/W19

Material	Aluminium, extruded
Surface	Powder-coated
Width	45 mm
Height	64 mm

Pulling element

Toothed belt

Material, notes	With steel insert
-----------------	-------------------

Drive variants

- Motor

Motor

- WM REA

Radio motor, optional

- WMS-WM (WMS)
- W-WM (EWFS)

+ see "Drive variants", Page 471

Construction limit values

Configuration variants	Minimum order width	Maximum order width	Minimum order length	Maximum order length	Maximum order area	Minimum inclination angle	Maximum inclination angle	Maximum order width of the group unit	Group unit, maximum order area
Fabric qualities									
Acrylic fabric / Starlight Blue / Twilight Pearl	770 mm	6000 mm	750 mm	6000 mm	30 m ²	0 °	45 °	12000 mm	60 m ²
Soltis 92	770 mm	3500 mm	750 mm	4500 mm	16 m ²	0 °	45 °	7000 mm	32 m ²
Fabric qualities + Supplementary accessories									
Acrylic fabric / Starlight Blue / Twilight Pearl + VUNO model	770 mm	6000 mm	750 mm	6000 mm	30 m ²	1 °	40 °	10000 mm	50 m ²
Acrylic fabric / Starlight Blue / Twilight Pearl + VUNO model	770 mm	5000 mm	750 mm	6000 mm	30 m ²	41 °	90 °	5000 mm	30 m ²
Soltis 92 + VUNO model	770 mm	3500 mm	750 mm	4500 mm	16 m ²	1 °	40 °	7000 mm	30 m ²
Soltis 92 + VUNO model	770 mm	3500 mm	750 mm	4500 mm	16 m ²	41 °	90 °	3500 mm	16 m ²

A maximum of two units can be coupled (driven by one motor).

Series-mounted units:

- The minimum width for the travelling unit is 290 mm.
- Each awning section requires two single guide rails.
- A maximum of two units can be coupled (driven by one motor).
- Two guide rails can be mounted on one bracket.
- In the case of a series-mounted unit, an expansion joint of 20 mm is required after 12000 mm!

Reinforcement profile:

Colours

- WAREMA Colour World

+ see "Colours and finishes", Page 10

Fabric qualities

- Acrylic fabric

Fabric qualities, optional:

- All Weather acrylic
- Starlight Blue
- Soltis 92
- Twilight Pearl

+ see "Awning collection", Page 460

Supplementary accessories

- Fabric lettering, painted

+ see "Supplementary accessories", Page 325

- For order lengths of 3001 mm and greater, a reinforcement profile is used.
- For order widths from 3501 mm or order lengths from 3001 mm, the Ø 40 mm profile is either equipped with a support or a Ø 60 mm profile is used.

Determining the weight of a Climara W19 conservatory awning (motorised unit)

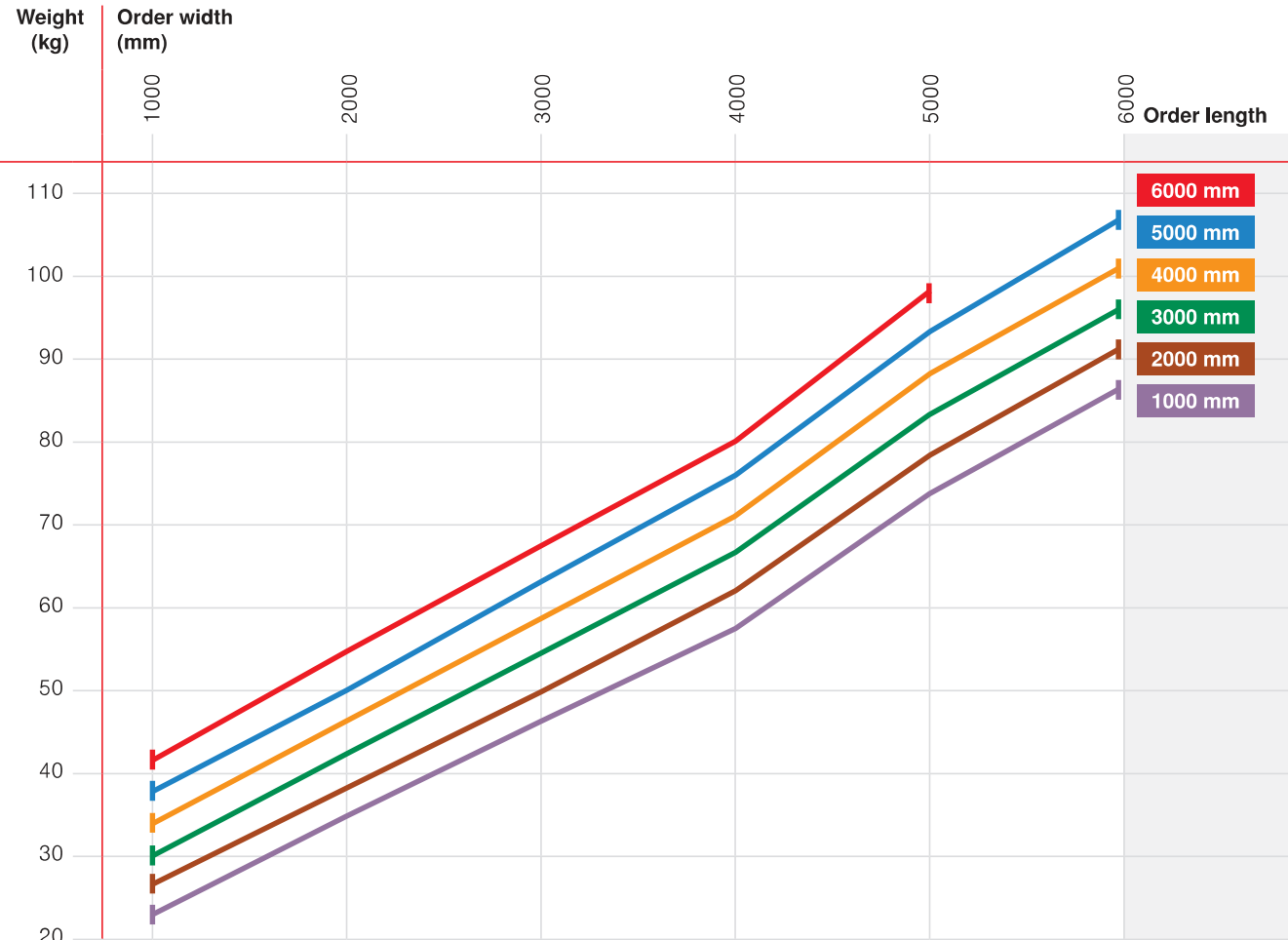

Dimensions

Weight per running metre: 15 - 17 kg/lfm
 Weight per running metre, notes: Cover panel without guide rail and bracket

Dimension determination

The **drive end or operation side** is always seen from the cover panel in extension direction.

Order width = guide rail axis to guide rail axis.

Measuring instructions - W19

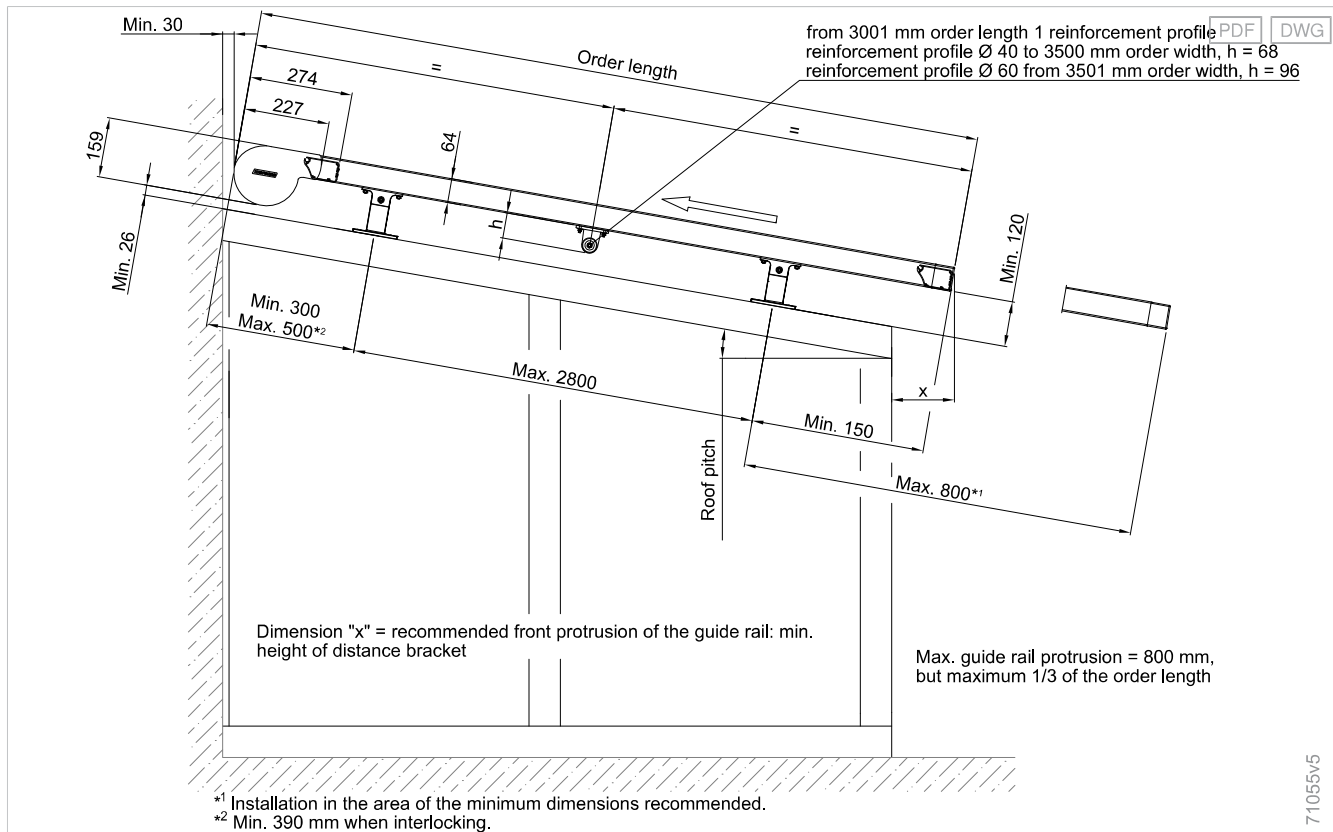

Direction of movement "from bottom to top" - W19

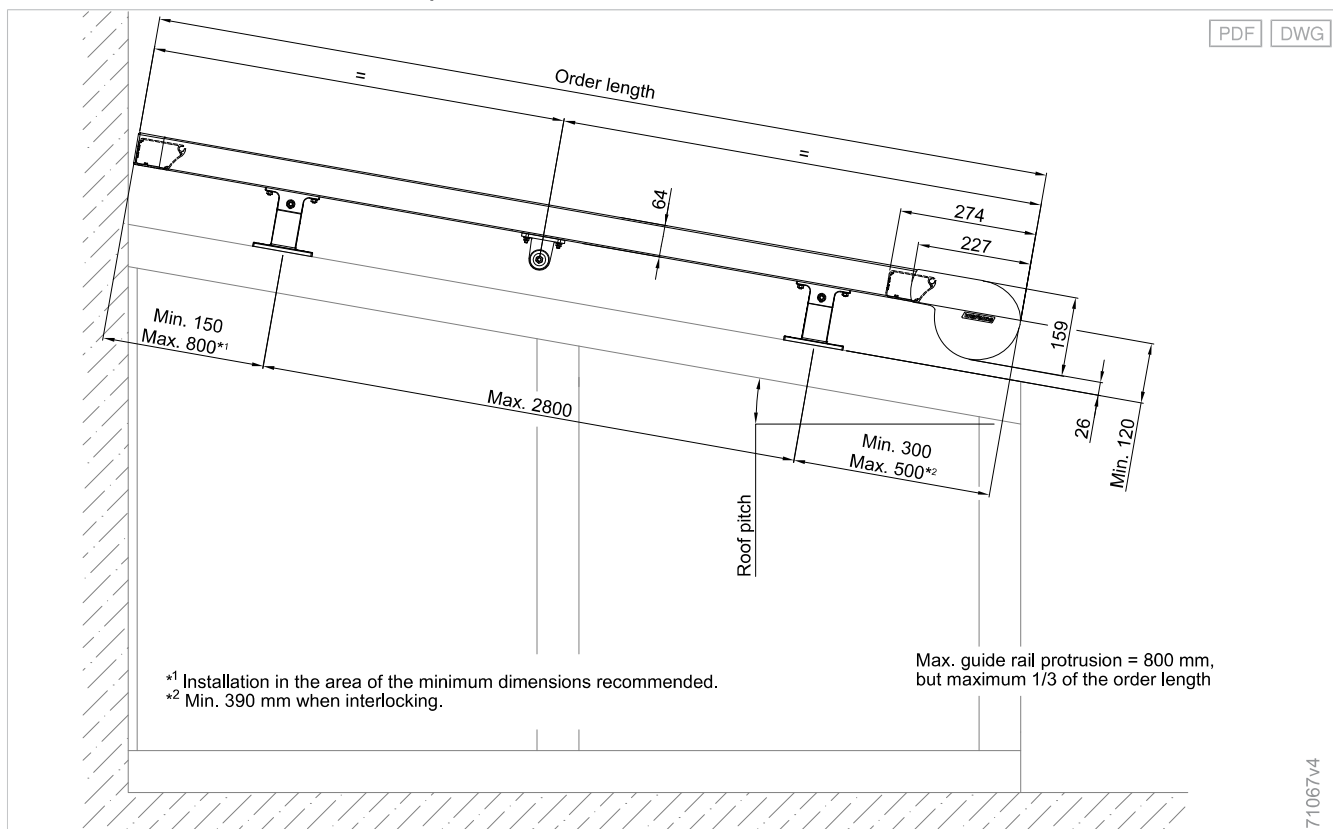

Individual unit - W9/W19

PDF DWG

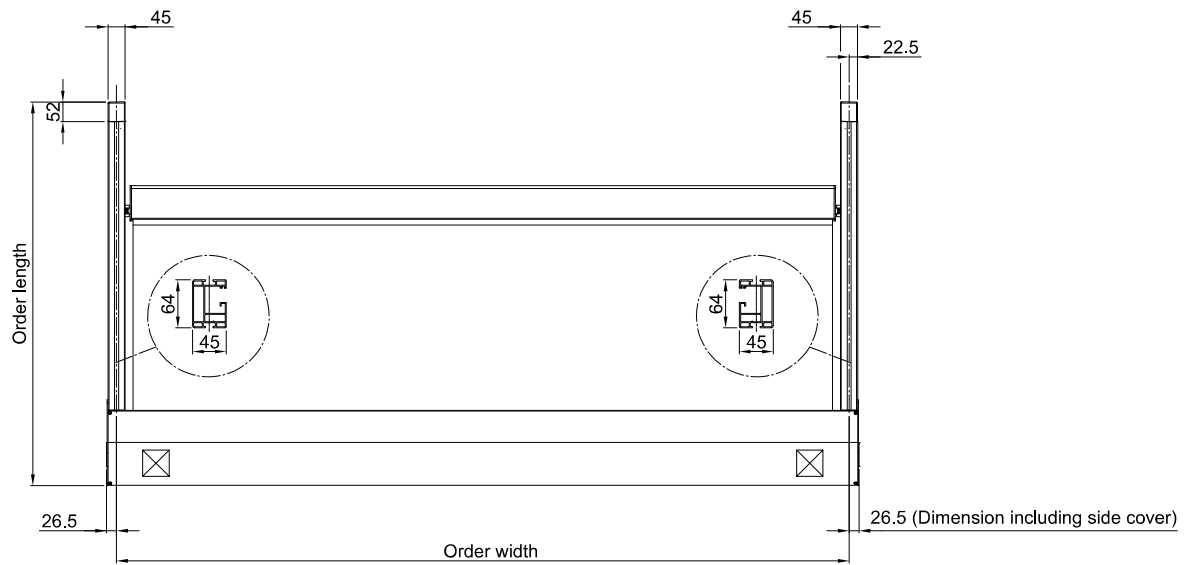

☒ Possible drive position

71040v3

Group unit - W19

PDF DWG

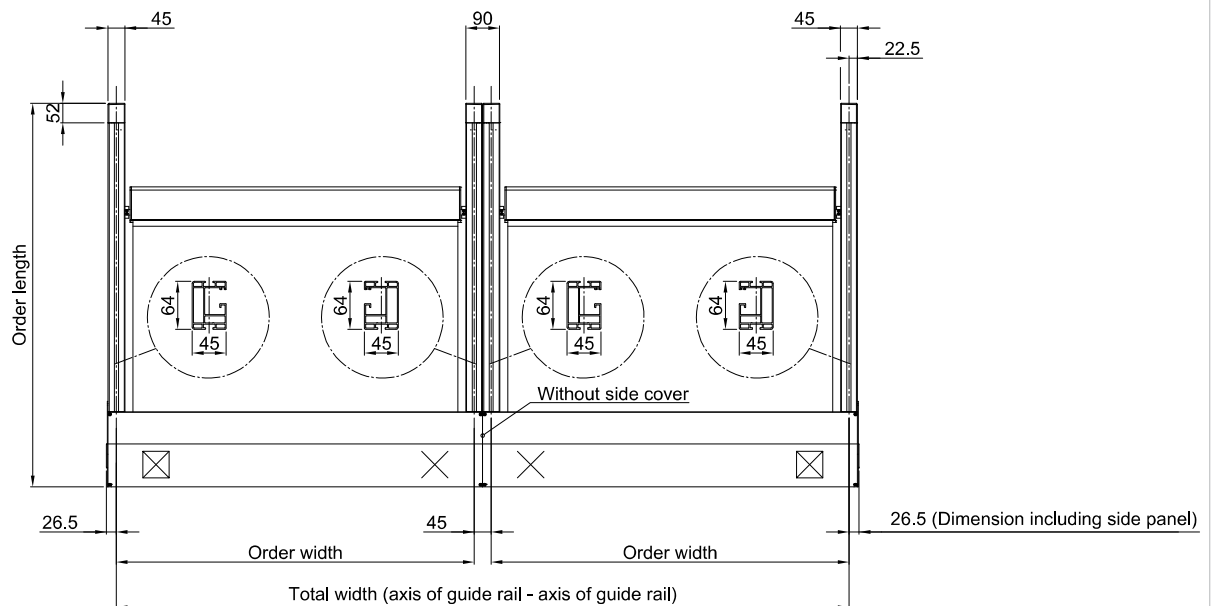

☒ Possible drive position
 ☒ Mechanically coupled

71056v4

Quantity determination

Number of guide rail brackets

Configuration variants	Order length	Number
Components		
Guide rail bracket - Climara conservatory awnings	0 - 3000 mm	2
Guide rail bracket - Climara conservatory awnings	3001 - 6000 mm	3

Details

Cable exit - W9/W19

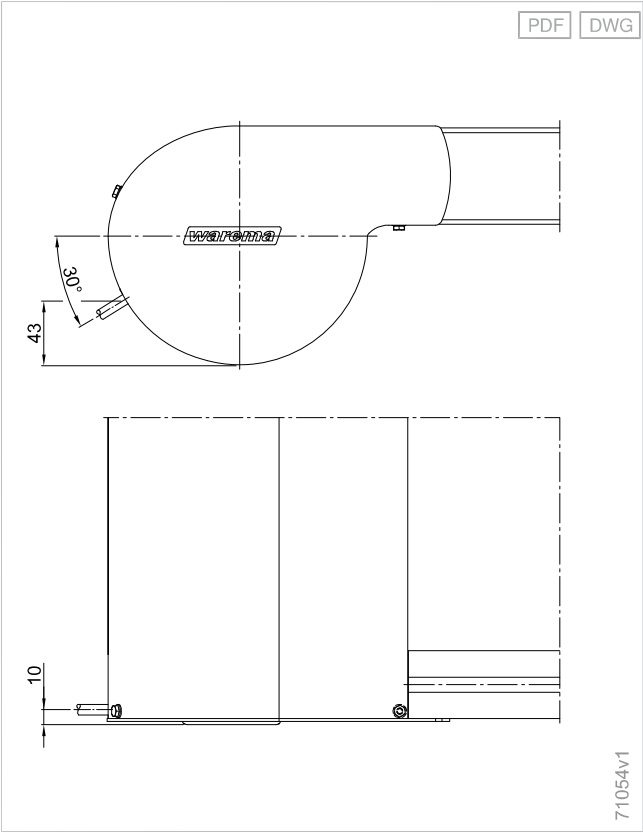

Housing for plug-in connector - W19/W20 round

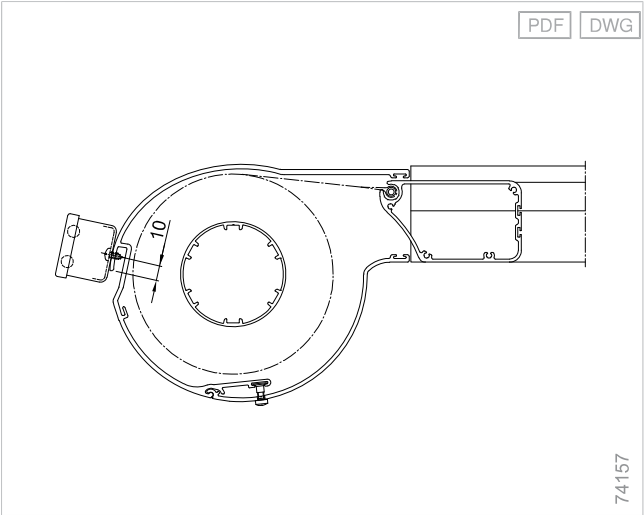

Guide rail - D3/W9/W19

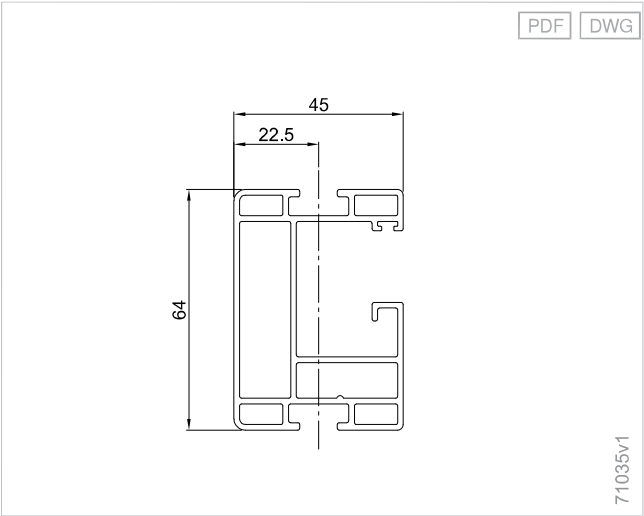

Support for reinforcement profile Ø 40 mm up to a bracket height of 170 mm- W19

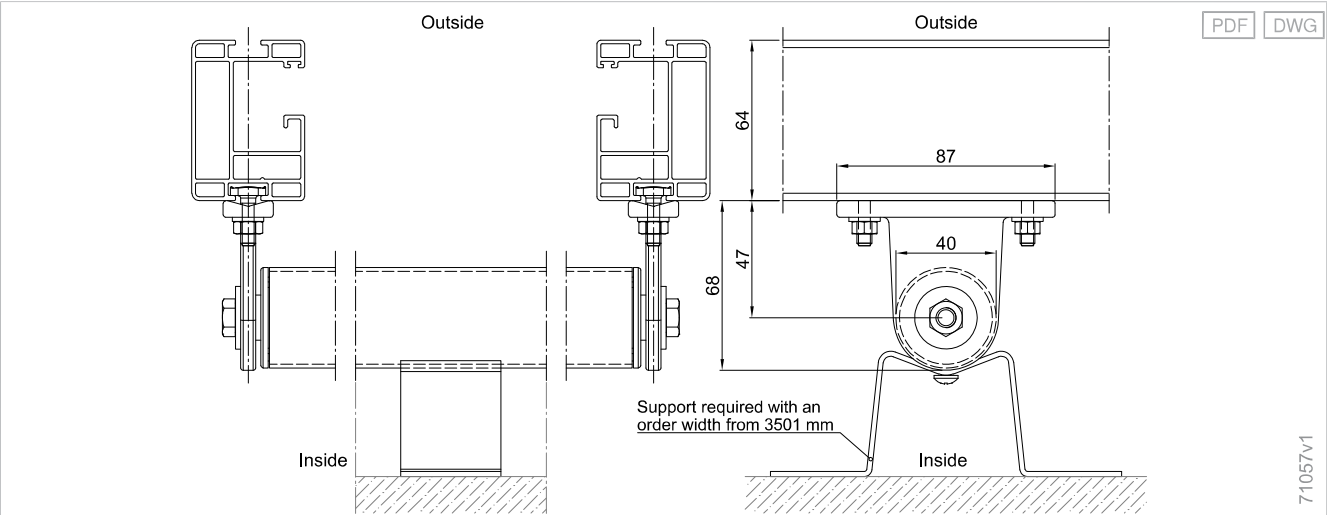

Support for reinforcement profile Ø 40 mm with a bracket height greater than 170 mm- W19

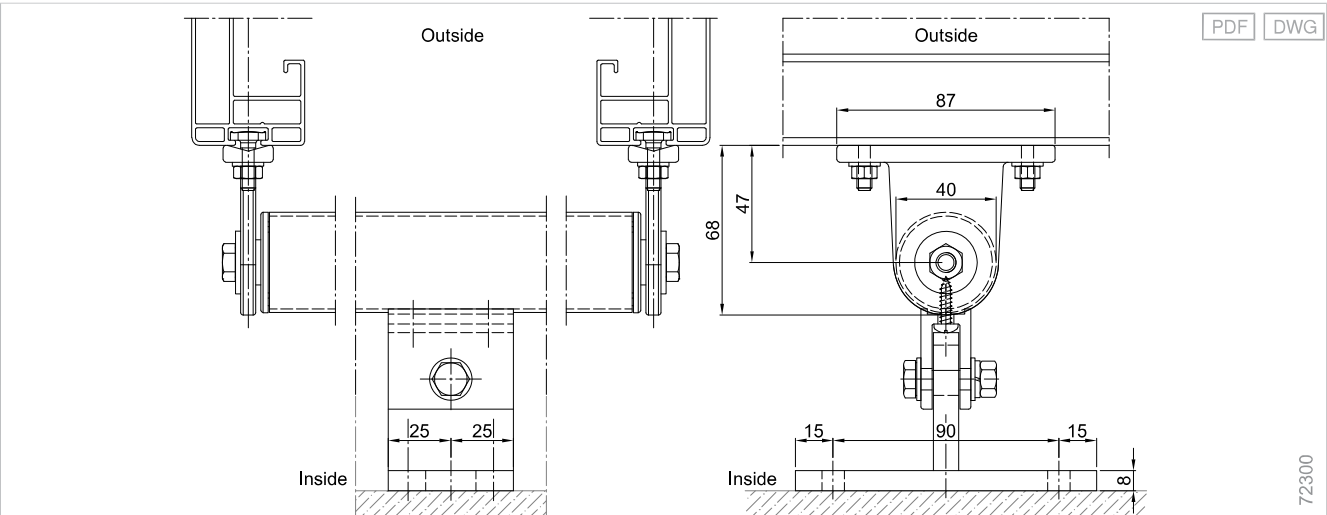

Reinforcement profile Ø 60 mm - W19

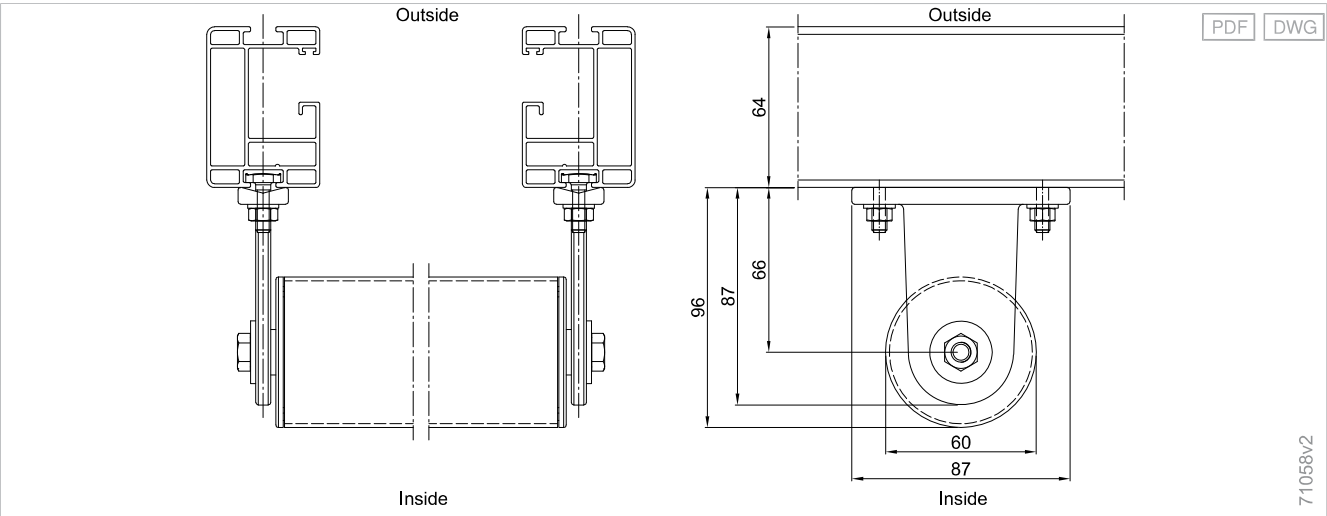

Bracket for connecting a WMS or EWFS weather station to the guide rail

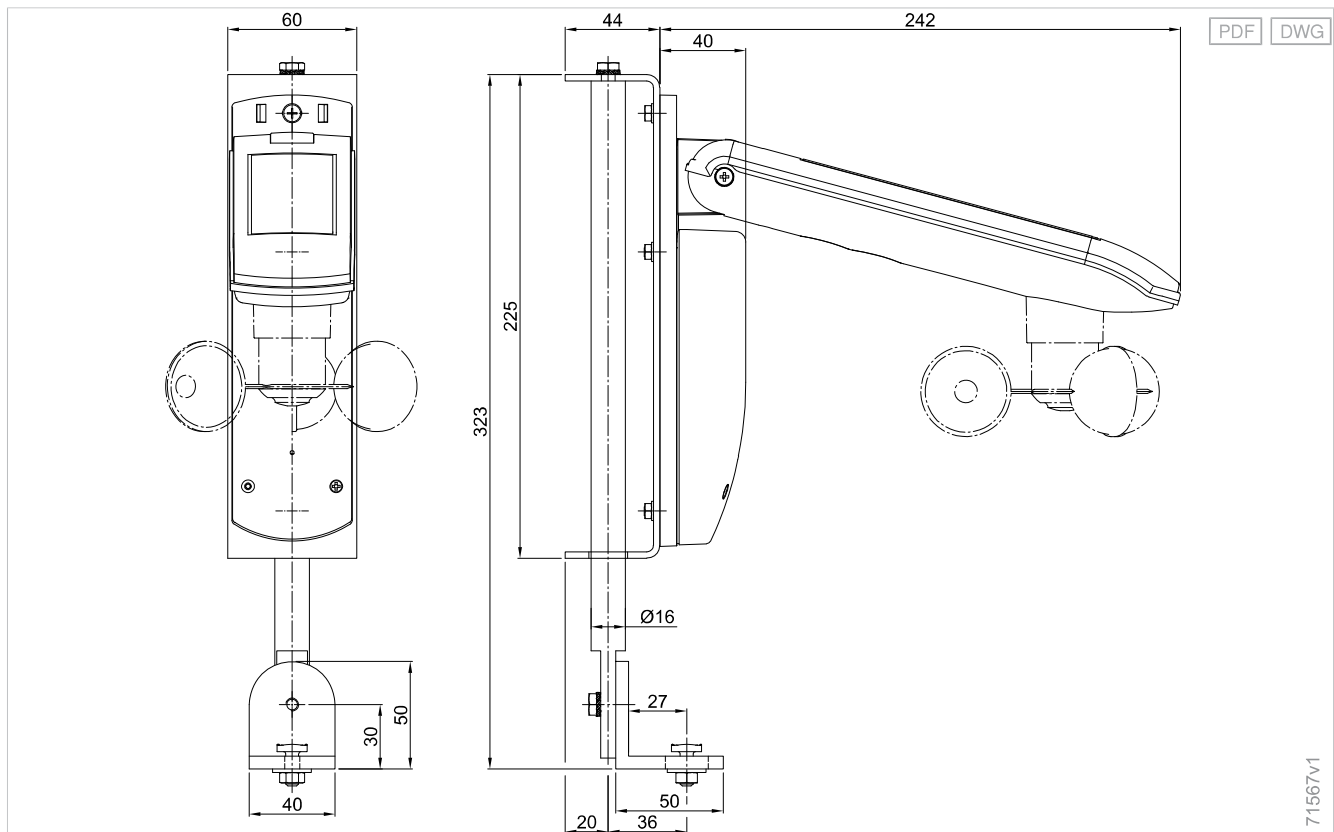

Additional product information

Guide rail bracket height greater than 300 mm

For a **guide rail bracket height of over 300 mm**, two Ø 60 mm reinforcement profiles with lateral supports are attached.

The maximum guide rail bracket height is 500 mm.

For a guide rail bracket height above 300 mm, the minimum order width is 900 mm.

The following components are used as standard:

- Bracket for rod
- Fixed Ø 60 mm reinforcement profile
- Welded bracket H101

The two reinforcement profiles are installed for every section of coupled conservatory awnings and series-mounted units. With series-mounted units, the two outer sections accommodate the support.

Support for cover panel and guide rail support - W19

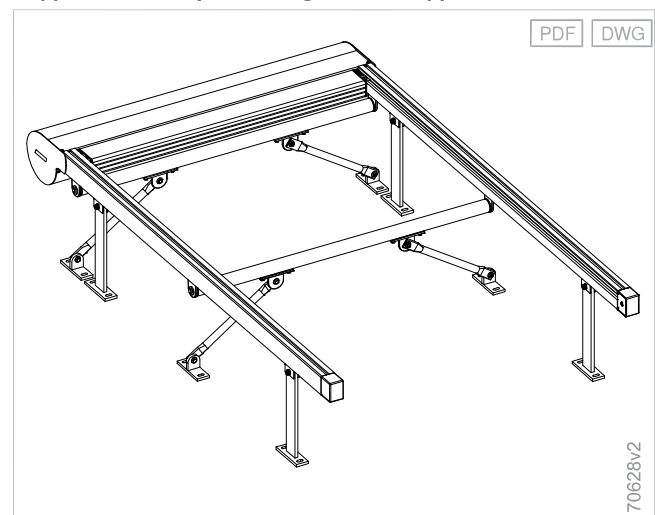

Support for series-mounted units

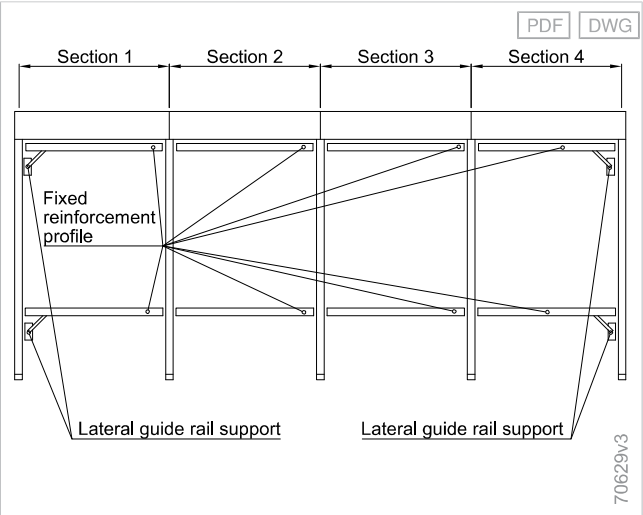

Bracket for reinforcement profile

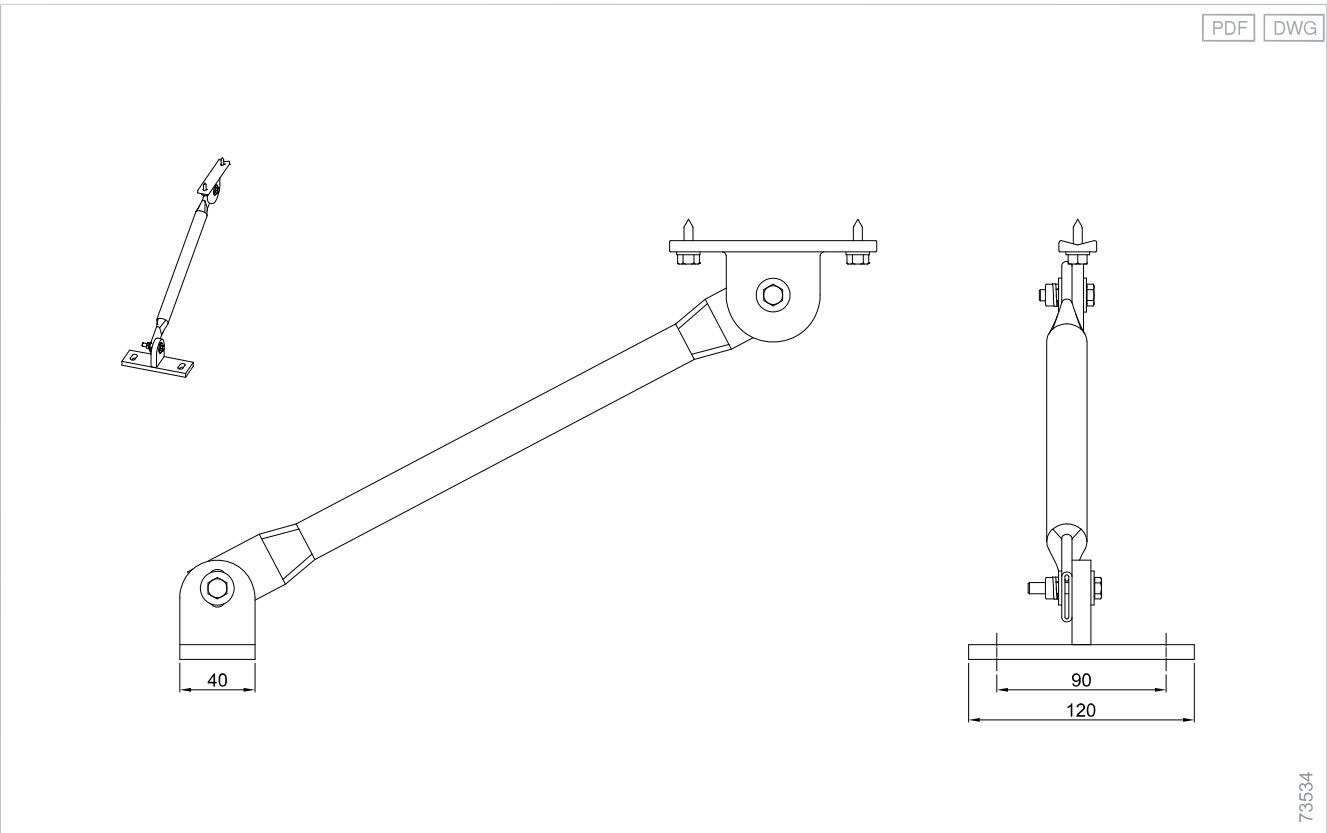

Klöckner-Moeller switch

When using a conservatory awning **W19 above a ventilation wing** (no smoke and heat venting system), it is necessary to use a Klöckner-Moeller switch.

This creates a mutual interlock between the conservatory awning W19 and the wing. That means that the conservatory awning will not extend as soon as the ventilation wing is opened and the wing will not open when the awning is extended.

The Klöckner-Moeller switch should always be mounted and operated in combination with a reed contact switch on the ventilation wing to ensure mutual interlocking.

For versions with Klöckner-Moeller switch, only a hard-wired motor is possible. A plug receiver cannot be used.

More information on request.

Klöckner-Moeller switch

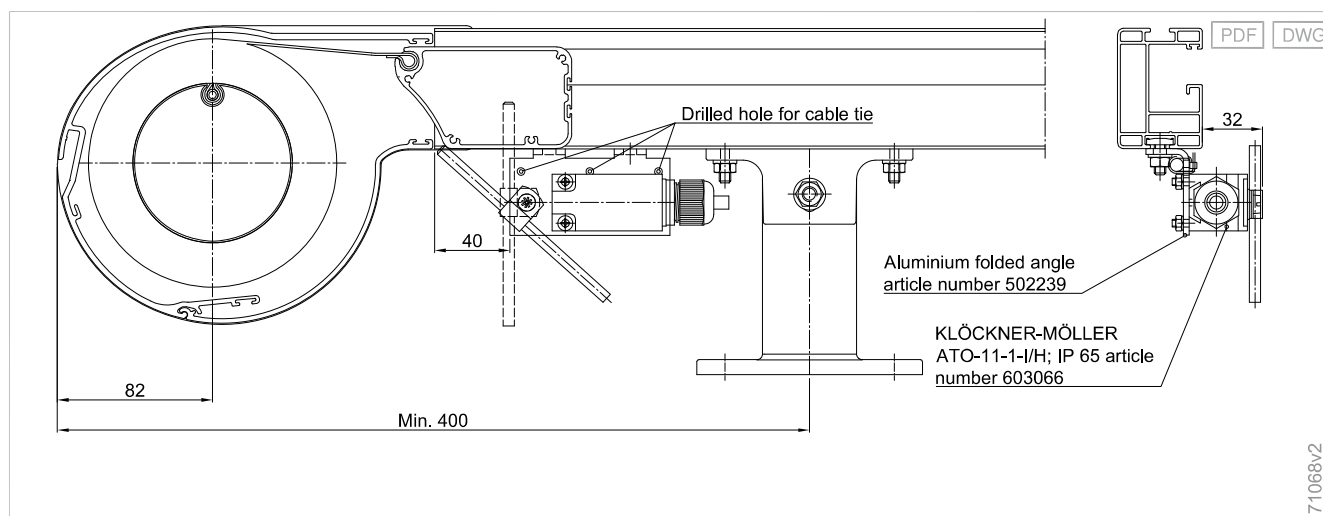

VUNO model

Climara conservatory awnings can be used with a "from bottom to top" direction of movement.

Notes:

- Each awning section requires two guide rails.
- Due to the cover panel opening in the extension direction there is an increased risk of the awning fabric becoming soiled.
- State clearly on the order form: Direction of movement "from bottom to top".
- State the roof pitch angle when ordering.

Mounting examples

Cover panel installation space - W19

